

brembana micra 2.0

3 Axis CNC sink bowl machine



Brembana MICRA 2.0 is the product of pure necessity. For quite a long time, the North American stone market needed a strong and versatile machine to carve out and polish SINK BOWLS with ease and accuracy.

Built in the USA with all the qualities of a standard Brembana CNC machine, the MICRA 2.0 is the strongest machine in its class.

With an 18 HP (13.5kW) standard Brembana Electro-Spindle and 10 position automatic tool changer, MICRA 2.0 has a working area of 40"X30". The machine is programmed by *CMS-SINK LINK* software which was created by our own expert programmers at CMS NA.

Brembana MICRA 2.0 combines maximum value with a minimum investment!

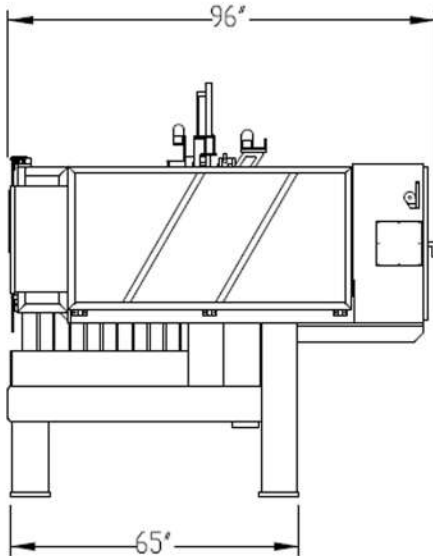
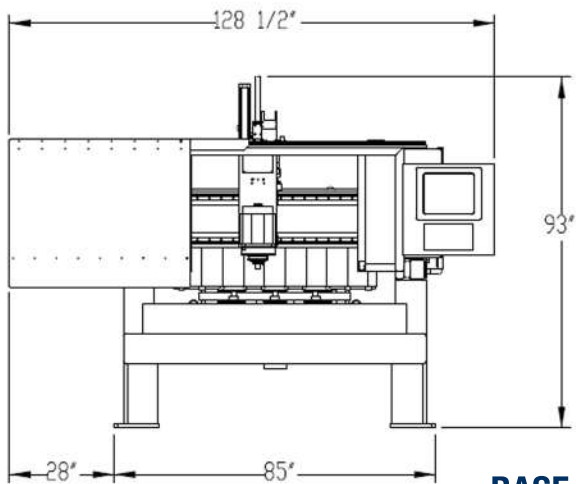

BASE MACHINE TECHNICAL DATA

X Axis maximum stroke	mm / "	1270 / 50"
Y Axis maximum stroke	mm / "	1016 / 40"
Z Axis maximum stroke	mm / "	229 / 9"
Work table dimensions X/Y	mm / "	1016/762 (40"/30")
Motor power and rotation speed (S9)	kW (HP) – rpm	13.5 (18) – 0+15000
Motor torque	Nm	22.6 @ 6000 RPM
Tool's maximum diameter	mm / "	150 / 6"
Number tools position	##	10
Minimum water pressure	bar (PSI)	4 (60)
Minimum air pressure	bar (PSI)	6 (95) – 5 CFM
Water consumption	1/gal/min	40/10.6
Standard- voltage and frequency	V- Hz	480V – 60Hz, 3 Phase
Special voltage and frequency	V - Hz	208 – 600V – 60 Hz, 3 Phase
Machine dimensions		128.5" X 96" X 93" h



EASY TO USE, ON-BOARD CMS-SINK LINK SOFTWARE WITH PARAMETRIC LIBRARY

HEAVY MONO-BLOCK CONSTRUCTION

18 HP (13.5kW) ELECTROSPINDLE



10 POSITION AUTOMATIC TOOL HOLDER

FAGOR 8070 OL CNC CONTROLLER